

# COMMODORE P

Multi-Purpose Workboat – Versatile & Fuel Efficient

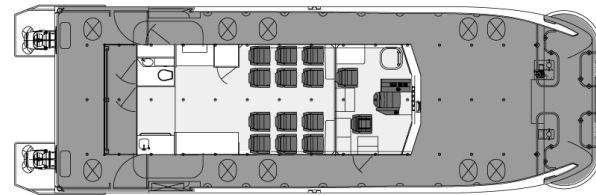

## MAIN PARTICULARS

Length	18.5m
Beam	6.1m
Draft	0.90m – 1.26m
Lightship	26 tonnes
Hull Material	Infused composite
Forward Deck Space	Up to 30m <sup>2</sup>
Aft Deck Space	Up to 30m <sup>2</sup>
Fresh Water	340 litres

## PROPULSION

Power	2 x Cummins QSM11 610Hp/455kW
Fuel Capacity	15,000 litres
Consumption	150 litres (total) per hour @2150rpm
Water Jets	2 x Rolls Royce FF41
Generator	Beta 11kW
Inverter	3kW, 240v
Cruising Speed	24 knots
Range	1,750 miles

## CLASSIFICATION

Vessel	MCA Category 2, 60 miles from a safe haven
Flag	UK
Passengers	12
Crew	3
Cargo	15 tonnes

## EQUIPMENT

Electronics	2 x Chartplotters, 2 x Radar, Sea Marshall PLB System, Class A AIS, GMDSS equipment for Sea Area A1
Fendering	RG Seasight
Life Saving Equipment	Flag compliance Cat 2
Vessel Interior	TV x 2, DVD, WiFi, Internal and External CCTV with Digital Video Recording, Crew Cabin, WC & Shower, Changing Area, Stretcher Facility, Hanging Storage, Warm Air Heating
Deck Equipment	Moveable Wheel House, Large Volume Fuel Transfer System, Forward Deck Crane available

