

COMMODORE P

Multi-Purpose Workboat – Versatile & Fuel Efficient

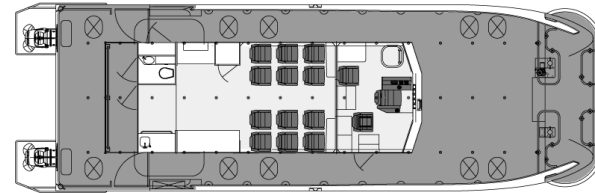

MAIN PARTICULARS

| | |
|--------------------|------------------------|
| Length | 18.5m |
| Beam | 6.1m |
| Draft | 0.90m – 1.26m |
| Lightship | 26 tonnes |
| Hull Material | Infused composite |
| Forward Deck Space | Up to 30m ² |
| Aft Deck Space | Up to 30m ² |
| Fresh Water | 340 litres |

PROPULSION

| | |
|----------------|--------------------------------------|
| Power | 2 x Cummins QSM11 610Hp/455kW |
| Fuel Capacity | 15,000 litres |
| Consumption | 150 litres (total) per hour @2150rpm |
| Water Jets | 2 x Rolls Royce FF41 |
| Generator | Beta 11kW |
| Inverter | 3kW, 240v |
| Cruising Speed | 24 knots |
| Range | 1,750 miles |

CLASSIFICATION

| | |
|------------|--|
| Vessel | MCA Category 2, 60 miles from a safe haven |
| Flag | UK |
| Passengers | 12 |
| Crew | 3 |
| Cargo | 15 tonnes |

EQUIPMENT

| | |
|-----------------------|---|
| Electronics | 2 x Chartplotters, 2 x Radar, Sea Marshall PLB System, Class A AIS, GMDSS equipment for Sea Area A1 |
| Fendering | RG Seasight |
| Life Saving Equipment | Flag compliance Cat 2 |
| Vessel Interior | TV x 2, DVD, WiFi, Internal and External CCTV with Digital Video Recording, Crew Cabin, WC & Shower, Changing Area, Stretcher Facility, Hanging Storage, Warm Air Heating |
| Deck Equipment | Moveable Wheel House, Large Volume Fuel Transfer System, Forward Deck Crane available |



ISO 9001
ISO 14001
ISO 45001
BUREAU VERITAS
Certification



3 Maypool Building, Brixham TQ5 0GD UK
Telephone: +44 (0)1803 845577 Email: info@offshoreturbinervices.co.uk